

The Inward Eye

September
2025

From the archives: Herbert Y. Meltzer, MD, at work in the University of Chicago laboratory — early in a career that helped shape modern psychopharmacology.

Table of Contents

→	Staffing Updates
→	Staff Spotlight
→	Education Mission
→	Clinical Mission
→	Department Spotlight
→	Research Mission
→	Publications
→	Contact

Faculty & Staff Updates

New Faculty and Staff

Geneice Lofton, LCSW

Licensed Clinical
Social Worker



Gina Sourelis-Smith, LCSW

Licensed Clinical
Social Worker



I'Sis (Izzy) Muller, RN

Registered Nurse



Edgar Woznica, MD

Psychiatrist



Shetal Amin, MD

Psychiatrist



Aja Hughes

Operations Coordinator



Departing Staff

Herbert Meltzer, MD

Professor of Psychiatry,
Pharmacology, and
Physiology



Debra Evins, RN

Nurse Operations Coordinator



Nora Meyers

Intake Coordinator



A Different World: Debbie Evins Reflects on 48 Years of Psychiatric Nursing

This summer, **Debbie Evins, RN**, officially retired after 48 remarkable years in psychiatric nursing at Northwestern.

When Debbie Evins began her career in psychiatric nursing nearly five decades ago, the landscape of patient care looked very different. Much of the healing process centered around long-term inpatient stays and community-building on the units themselves.

"Patients stayed for weeks to months," Debbie recalls. "Patient treatment included individual therapy, family therapy, milieu therapy, meds, and skill-building experiences. We did so many life-experiences together, taking patients shopping, going to see fireworks on July 3rd. It was a different world."

Daily team meetings brought together nurses, social workers, occupational therapists, residents, and attendings to review cases and learn from one another. "It was a team experience," she says. "The unit chief would often teach, and even the department chair came to listen to presentations. Everyone understood the psychodynamics of the patients we were caring for."



Debbie Evins with the psychiatry nursing team.



Over time, she watched psychiatry shift toward shorter inpatient stays and greater reliance on outpatient, one-to-one therapy. "Long-term inpatient treatment shifted to shorter-term, more acute care," she explains. "Nursing has always been about caring, but the way we execute that role has changed."

For Debbie, some of the most rewarding moments came from working with the chronically ill, those living with ongoing psychiatric conditions that couldn't always be "cured" but could be managed with care, consistency, and patience. "I loved working with people who needed more life-skill training, who needed help learning to live meaningful lives despite their pervasive symptoms," she says. "It was rewarding, because I knew people could get better and I knew nursing played a large part in that process."

Even in recent years, Debbie continued to embrace change. Nurses today maintain a critical role working with and supporting both patients and providers. They are also active participants in treatments such as ketamine and TMS, reflecting the adaptability of the profession and its central role in advancing patient care.

Looking back, Debbie sees the arc of psychiatry not as a loss, but as an evolution. "It's always about relationships," she says. "That's the heart of nursing, it never changes, no matter how much the field does."

As Debbie prepares for retirement, the Department of Psychiatry and Behavioral Sciences celebrates not only her 48 years of service, but the countless lives she has touched along the way. Her compassion, leadership, and steady presence have left an indelible mark on patients, colleagues, and the culture of psychiatric nursing at Northwestern. We thank Debbie for her extraordinary dedication and wish her the very best in this next chapter.

James Dickson, MD, Recognized Among Top Poster Presenters at ACLP Annual Meeting

We're excited to share that James Dickson, MD has been selected as one of the top-scoring presenters at this year's Academy of Consultation-Liaison Psychiatry (ACLP) Annual Meeting. His poster, "Qualitative Examination of Barriers and Facilitators to Primary Care Screening and Referral to a Collaborative Care Program," was recognized by judges for its excellence and impact.

As a result, Dr. Dickson's work will be featured in an upcoming issue of ACLP News.

Congratulations on this outstanding achievement!



James Dickson, MD
PGY4

Celebrating Excellence in Clinical Education: Residents Recognized by Feinberg Students

Trainee Achievement Recognition

We are proud to recognize **Drs. Courtney Amegashie, Benjamin Bowlby, James Hammock, Ali Kalam, Michael Park, Brandon Rafidi, Trevar Ziemer, and Zachary Bean** for receiving multiple student nominations for their exemplary role modeling in the clinical learning environment.

Feinberg Recognition Program, 2024–2025

These eight trainees were among just 58 across the institution honored for their professionalism, compassion, and dedication to excellence in patient care and education.

Your impact on medical students and the Feinberg community is deeply appreciated.

Thank you, and congratulations!



Michael Park, MD



Courtney Amegashie, MD



Brandon Rafidi, MD



Benjamin Bowlby, MD



Trevar Ziemer, MD



James Hammock, MD



Zachary Bean, MD



Ali Kalam, MD

Construction on Arkes 11 is taking place in two phases, beginning Monday, Sept 15, with completion expected by the second week of January.

Timeline & Logistics

Temporary Break Room (Room 11-164):

- Currently under construction and will be ready Monday, Sept 29.
- This space will also include the copier, mailboxes, refrigerator, microwave, and sink — but no seating or tables.

Current Break Room:

- Remains available through Friday, Sept 26.
- Please remove all food, dishes, and personal belongings by the end of that day.

Supply Closet Relocation:

- Items from the northwest corridor are being moved to Closet 11-017
- (located across from the freight elevator and requires badge access).

Phase 2 (Begins Saturday, Sept 27):

- The copier and mailboxes will be moved to Room 11-164.
- Construction will begin on new consult rooms and a ketamine suite.
- The northwest corridor will be closed until mid-January.

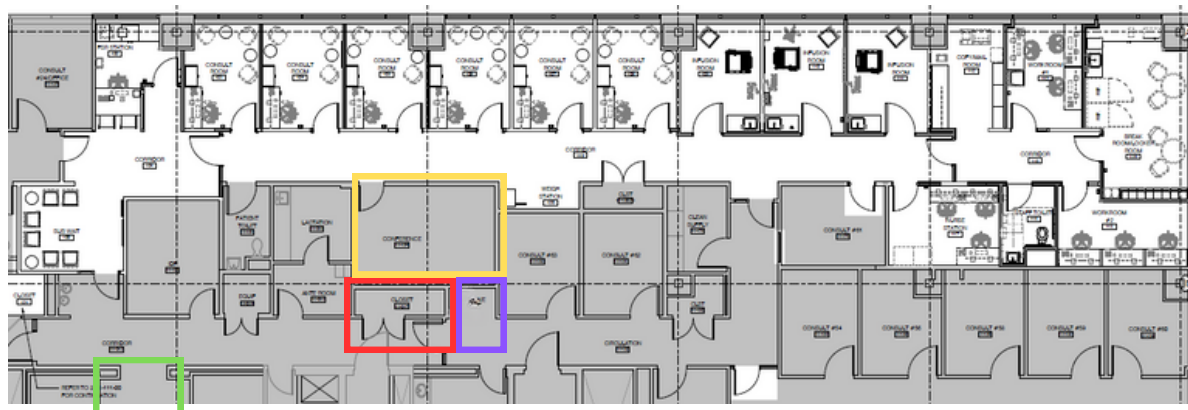

- Elevators ● New Supply Closet ● New Break Room ● New Entrance to Break Room

Clinical Mission Update: New Faculty & Program Launch

As summer transitions into fall, our Department marks another season of growth and innovation.

We're excited to welcome two new faculty members: **Dr. Shetal Amin** (Emergency Psychiatry) and **Dr. Edgar Woznica** (Addiction Psychiatry). We look forward to the expertise and energy they bring to our clinical mission.

This fall also marks the soft launch of the Psychiatry Problem Focused Clinic (PPFC) — a new initiative designed to expand access to short-term mental health care. Patients referred to the PPFC will receive an intake appointment within one week and begin working with an APN for up to 12 weeks of care. Services will include medication management, brief individual psychotherapy, skills-based group treatment, and transition support.

Short-term care remains an underutilized but highly effective modality. With evidence supporting meaningful outcomes in just a few months, we're proud to bring this model to Northwestern and expand access to those who need timely, focused support.

Dr. Will Cronenwett, Vice Chair of Clinical Affairs



A Life in Science and Service: Dr. Herbert Meltzer Retires



After more than 55 years of groundbreaking work in psychiatry, Dr. Herbert Y. Meltzer officially retired this year, marking the close of a remarkable career that began with his residency in 1966.

Dr. Meltzer's career spans the very arc of modern neuropsychopharmacology: educated at Cornell, Harvard, and Yale, he trained alongside and learned from scientific giants (including Nobel laureates James Watson, Francis Crick, and Eric Kandel) and formative mentors such as Daniel X. Freedman and Tom Detre. He went on to collaborate with leaders including Edward Sachar, Jack Durrell, and early on in 1976 — Stephen M. Stahl, who later established the Stephen M. Stahl Center for Psychiatric Neuroscience here at Northwestern.

Clinically and scientifically, Dr. Meltzer helped bring clozapine and other atypical antipsychotics to the forefront of care, elucidating their mechanisms and demonstrating clozapine's superiority for treatment-resistant schizophrenia and its unique role in reducing suicide attempts (InterSePT), work that has changed countless lives. His leadership and program building stretched across the National Institute of Mental Health, the University of Chicago, Case Western Reserve, Vanderbilt University, and ultimately back to Northwestern.

Along the way he earned the Efron and Paul Hoch Awards (ACNP), the Lieber Prize (BBRF), the Dean Award for Research in Schizophrenia (American College of Psychiatry), the Gold Medal Award (Society of Biological Psychiatry), the APA Research Prize, Vanderbilt's Sutherland Prize and Grant Liddle Award, and a Lifetime Achievement Award from the Schizophrenia International Research Society — all while authoring hundreds of papers cited well over 100,000 times.

From our entire department: Thank you, Dr. Meltzer, for your vision, mentorship, and truly remarkable service to science and to patients.

Luis Rosas-Vidal, MD, PhD

Assistant Professor, Psychiatry and Behavioral Sciences
(General Psychiatry)

Advancing care for anxiety and trauma-related disorders



About Dr. Rosas-Vidal

Dr. Luis Rosas-Vidal is an assistant professor of Psychiatry and Behavioral Sciences (Division of General Psychiatry) and a physician-scientist. Clinically, he cares for patients with severe affective and psychotic disorders on the inpatient psychiatric unit. In the lab, his team uses circuit-level approaches — paired with genetic and pharmacological tools — to map the neural pathways that govern defensive responses (fear and anxiety) and to study how opioids alter those circuits.

Research focus

“My work centers on how symptoms of excessive fear and anxiety arise from specific neural circuits. I’m interested in how neurotransmitters and neuropeptides tune those circuits, and how those changes play out in behavior.”

Ultimate goal

“We aim to reveal how defensive behaviors and emotions are regulated so we can sharpen diagnosis and improve treatments for anxiety and trauma-related disorders.”

Path to this field

“As a medical student, I was drawn to Dr. Gregory Quirk’s pioneering research on fear extinction and prefrontal control of fear. I started as a volunteer in his lab, was immediately hooked, and later completed my PhD training there.”

Campus collaborations

“I collaborate closely within our department’s Stephen M. Stahl Center for Psychiatric Neuroscience, including work with Reesha Patel, PhD, Hao Li, PhD, and Sachin Patel, MD, PhD.”

Recent publications

Journal of Clinical Investigation; Neurobiology of Stress; Psychopharmacology.

Mentors & inspiration

“I’m inspired by my family, my patients, and colleagues committed to doing what’s right. I’m grateful for the mentorship of Drs. Gregory Quirk and Sachin Patel.”

This spotlight draws from Dr. Rosas-Vidal’s faculty profile originally published in Northwestern’s Breakthroughs newsletter.

FACULTY ACHIEVEMENT RECOGNITION

CELEBRATING OUR FACULTY

We are proud to recognize **Drs. Brandon Hamm, Kaitlyn Kunstman, and Chandrika Shankar** for receiving multiple student nominations for their exemplary role modeling in the learning environment.

**Feinberg Recognition Program,
2024-2025**

These three faculty members were among just 28 across the institution honored for their professionalism, mentorship, and dedication to medical education.

Your impact on our trainees and culture of excellence is deeply appreciated.

Thank you, and congratulations!



Brandon S. Hamm, MD



Kaitlyn N. Kunstman, MD



Chandrika N. Shankar, MD

Media

Northwestern's SuperAging Program Marks 25 Years with Landmark Publication

Drs. Sandra Weintraub, Tamar Gefen, Changiz Geula, and M. Marsel Mesulam of the Northwestern University SuperAging Research Program (NUSAP) recently published a landmark perspective piece titled *"The First 25 Years of the Northwestern University SuperAging Program"* in *Alzheimer's & Dementia: The Journal of the Alzheimer's Association*.

The publication has garnered widespread attention, with coverage in multiple media outlets — including international platforms. Use the links below to explore each featured story.

- **The New York Times** - ["The One Quality Most 'Super-Agers' Share"](#)
- **NBC News (national)** - ["New research reveals clues about memory from the brain of 'SuperAgers'"](#)
- **NPR, Short Wave** - ["Why do some people's memories stay sharp as they age?"](#)
- **CNN** - ["80-year-old 'SuperAger' brain operates like that of a 50-year-old. Here's why"](#)
- **BBC** - ["Scientists spent 25 years studying 'super-agers'. Here's what they learned"](#)
- **STAT** - ["Superagers' brains offer clues to cognitive resilience, and possible treatments, researchers say"](#)
- **The Times** - ["Friendship, not fitness, linked to sharp memory later in life"](#)
- **National Geographic** - ["Superagers' seem to share this one key personality trait"](#)
- **New York Post** - ["These special traits may shield 'SuperAgers' from dementia — how they could lead to new Alzheimer's tools"](#)
- **MedPage Today** - ["Superagers' Brains Are Different: Here's How"](#)
- **Yahoo** - ["SuperAgers over 80 show memory equal to adults in their 50s, study finds"](#)
- **Fox News Health** - ["Study reveals why 'super agers' maintain 'outstanding memory' into their 80s"](#)
- **International Hospital & Equipment** - ["25-year study reveals how SuperAgers defy cognitive decline"](#)
- **Inside Precision Medicine** - ["Neuroprotective Biomarkers Identified in 'SuperAger' Brains"](#)
- **Ciencia Contada en español (SINC Spanish outlet)** - ["How to Reach 80 with a 50-Year-Old Brain: Superagers Defy Age"](#)
- **infobae (Spanish outlet)** - ["The SuperAgers phenomenon: unique brain traits identified in people with exceptional memory"](#)
- **65 y más (Spanish outlet)** - ["The 'SuperAgers' Who Age Without Losing Their Memory"](#)
- **Spektrum der Wissenschaft (German outlet)** - ["What distinguishes the brains of mentally fit seniors"](#)
- **Le Figaro (French outlet)** - ["Some smoke, others drink, and they don't always eat healthy foods: the incredible memory of 'superagers' still fascinates science"](#)



Sandra Weintraub, PhD

Professor, Psychiatry and Behavioral Sciences (Psychology), Neurology - Ken and Ruth Davee Department



Tamar Gefen, PhD

Associate Professor, Psychiatry and Behavioral Sciences (Psychology)



Changiz Geula, MD

Research Professor, Cell and Developmental Biology
Research Professor, Mesulam Center for Cognitive Neurology and Alzheimer's Disease



M. Marsel Mesulam, MD

Chief of Behavioral Neurology
Ruth Dunbar Davee Professor of Neuroscience

Media

The Northwestern Project Featured in Local and National Media

In April, The Northwestern Project's work on youth justice and detention reform drew broad coverage: [WBEZ's The Rundown \(Apr 21\)](#) featured Dr. Sara Thomas; the [Chicago Tribune](#) spotlighted her expert commentary in a piece on raising Illinois' minimum detention age; and [Northwestern Now](#) highlighted research by Drs. Linda Teplin and Sara Thomas on improving outcomes for justice-involved youth.

Conferences & Presentations

Papadakis, J. L., Eisenman, S. R., Buchanan, C. L., & Chen, D. (2025, April). *The role of social support in medical decision-making: Perspectives from adolescents and young adults with differences of sex development/ variations in sex characteristics and their caregivers*. In K. Suorsa's (Chair), *Social and peer support among adolescents and young adults with differences of sex development/ variations in sex characteristics: Implications and solutions to improve health equity* [Symposium presentation]. Society of Pediatric Psychology Annual Conference, Phoenix, AZ, United States.

Papadakis, J. L., Suhs, M. C., O'Donnell, A., Harris, M. A., & Weissberg-Benchell, J. (2025, June). *Behavioral Family System Therapy for Diabetes-Transition (BFST-DT): Group-based family intervention with adolescents with type 1 diabetes in preparation for transition to adult care*. In S. Carreon's (Chair), *Ready, set, go: Outcomes of behavioral transition interventions for adolescents and young adults with diabetes* [Symposium presentation]. 85th Scientific Sessions of the American Diabetes Association, Chicago, IL, United States.

Suhs, M. C., Ellis, J., O'Donnell, A., Weissberg-Benchell, J., Harris, M. A., & Papadakis, J. L. (2025, April). *Discrepancies in caregiver and adolescent perceptions of family functioning and associations with transition readiness among adolescents with type 1 diabetes* [Poster presentation]. Society of Pediatric Psychology Annual Conference, Phoenix, AZ, United States.

Rouse, C., Hayes, L. C., Papadakis, J. L., Shepard, S., & Soohoo, M. (2025, April). *Uropsychology: An emerging specialty for pediatric psychologists* [Poster presentation]. Society of Pediatric Psychology Annual Conference, Phoenix, AZ, United States.

Smith, J. B., Corona, L. E., Talston, A., Hirsch, J., Rosoklija, I., Whitehead, J., Papadakis, J. L., Chen, D., Finlayson, C., Cheng, E. Y., Yerkes, E. B., & Johnson, E. K. (2025, April). *Qualitative analysis of decisional dynamics about gonadectomy and gonadal tissue cryopreservation among families of individuals with differences of sex development* [Poster presentation]. American Urology Association Meeting, Las Vegas, NV, United States.

Tubman, A., Papadakis, J. L., Finlayson, C., Duquette, D., & Weisman, A. G. (2025, May). Exploring the understanding and perspectives of adolescents and young adults with Klinefelter syndrome: Testosterone supplementation, infertility, and cognitive and psychological impacts [Poster presentation]. Pediatric Endocrinology Society Annual Meeting in National Harbor, MD, United States.

Conferences & Presentations

Ratnam, S., Papadakis, J. L., Goetsch Weisman, A., Leeth, E., Huit, T., Lee, D., Tubman, A., Pothast, K., Lucio, L., Brickman, W., & Finlayson, C. (2025, May). *KidS Camp: Encouraging Physical Fitness and Positive Self-Concept in Adolescents with Klinefelter Syndrome* [Poster presentation]. Pediatric Endocrinology Society Annual Meeting in National Harbor, MD, United States.

Lapping-Carr, L., Almås, E., Fox, C., Coleman, E., Giami, A., & Janssen, E. (2025, August). *Perspectives on sexology as a profession: A roundtable discussion*. In L. Lapping-Carr & E. Almås (Chairs). Symposium conducted at the World Association for Sexual Health 27th Congress, Brisbane, Australia.

Salvati, J.M., Aaby, D.A., Abram, K.M., Welty, L.J., Teplin, L.A. (2025, May). *Intergenerational Delinquency: A Prospective Study of High-Risk Families*. In Teplin, L.A. (Chair) Intergenerational Transmission of Substance Use Disorders, Crime, and Firearm Involvement in High-Risk Families. Symposium conducted at the 2025 Association for Psychological Science (APS) Annual Convention, Washington, D.C.

Thomas, S.E., Salvati, J.M., Aaby, D.A., Welty, L.J., Abram, K.M., Teplin, L.A. (2025, May). *Firearm Involvement in Parents and their Adolescent Children: Intergenerational Patterns of Firearm Violence*. In Teplin, L.A. (Chair) Intergenerational Transmission of Substance Use Disorders, Crime, and Firearm Involvement in High-Risk Families. Symposium conducted at the 2025 Association for Psychological Science (APS) Annual Convention, Washington, D.C.

Luna, M.J., Teplin, L.A., Aaby, D.A., Welty, L.J., Abram, K.M. (2025, May). *Intergenerational Transmission of Substance Use Disorders: A Prospective Study of High-Risk Families*. In Teplin, L.A. (Chair) Intergenerational Transmission of Substance Use Disorders, Crime, and Firearm Involvement in High-Risk Families. Symposium conducted at the 2025 Association for Psychological Science (APS) Annual Convention, Washington, D.C.

Grants

The division of Psychiatry and the Law was awarded an annual, renewable grant through IDHS, Division of Behavioral Health and Recovery titled 230 Outpatient Fitness Restoration. The grant provides funds to establish an outpatient clinic to restore fitness to individuals adjudicated unfit to stand trial through psychiatric treatment and legal education. Dr. Scott Gershan will serve as clinic medical director, Dr. Rueben Heyman-Kantor will serve as lead treatment psychiatrist, and Dr. Michelle Hoy-Watkins will serve as lead legal education provider.

Agency: Patient-Centered Outcomes Research Institute (PCORI)
Title: Bowel Continence Across the Lifespan in Spina Bifida (BCALS)
Principal Investigator: David Chu, MD
Role on project: Co-Investigator
Project period: August 2025 - July 2030

Principal Investigator(s): Dr. Leiszle Lapping-Carr
Student-Investigator: Peter Cummings
Funding agency: Osher Center for Integrative Health at Northwestern University, Osher Pilot Research Awards
Title: Development of affective resilience optimized for gender diverse individuals (DAFFODIL)
Project Period: July 2025 - June 2026

7TH ANNUAL BROOKSTONE CONFERENCE

Bridging the Gap Between Research and Practice in Youth Psychiatric Care

One in five youth live with a mental or behavioral health condition. Yet effective psychiatric treatments often fail to reach the youth who need them most. This year's Brookstone Conference will highlight how implementation science can bridge the gap between evidence-based care and everyday practice.

2025 CONFERENCE CHAIR & HOST SARA BECKER, PHD

*Alice Hamilton Professor of Psychiatry
Inaugural Director, Center for Dissemination and Implementation Science*



2025 CONFERENCE CO-HOST DENNIS LI, PHD, MPH

*Assistant Professor of Psychiatry and Behavioral Sciences
Center for Dissemination and Implementation Science*



2025 KEYNOTE SPEAKER JULIA MOORE, PHD

The Center for Implementation Science



 Hughes Auditorium
303 E. Superior Street, Chicago, IL 60611

Wednesday, October 8th, 2025

 1:00–6:00 PM CT

PLEASE RSVP HERE

Publications

The Health Disparities & Public Policy (HDPP) program recently published an article on incarceration and psychosocial outcomes in the *Journal of the American Academy of Child & Adolescent Psychiatry (JAACAP)* — the leading journal in the field. Dr. Sara Thomas was the first author.

In recognition of the paper's significance, the journal just released an editorial, **First, Do No Harm: Findings from a 16-year Study on Juvenile Detainees**, reflecting on the article. Click the links below to read both publications online ahead of their print release.

- You can read the article here: [https://www.jaacap.org/article/S0890-8567\(25\)00184-4/fulltext](https://www.jaacap.org/article/S0890-8567(25)00184-4/fulltext)
- You can read the editorial here: [https://www.jaacap.org/article/S0890-8567\(25\)00325-9/fulltext](https://www.jaacap.org/article/S0890-8567(25)00325-9/fulltext)

Thomas, S. E., Abram, K. M., Aaby, D., Welty, L. J., Arzu, J. L., Salvati, J. M., & Teplin, L. A. (2025). Incarceration and Subsequent Psychosocial Outcomes: A 16-Year Longitudinal Study of Youth After Detention. *Journal of the American Academy of Child and Adolescent Psychiatry*, S0890-8567(25)00184-4. Advance online publication. <https://doi.org/10.1016/j.jaac.2025.04.004>

Tastenhoye, C. A., & McBride, A. B. (2025). Editorial: First, Do No Harm: Findings from a 16-year Study on Juvenile Detainees. *Journal of the American Academy of Child and Adolescent Psychiatry*, S0890-8567(25)00325-9. Advance online publication. <https://doi.org/10.1016/j.jaac.2025.06.021>

Congratulations to Dr. Jason Washburn on the recent publication of the paper “Non-suicidal self-injury: proposal to shift designation from disorder to a clinical specifier” in *The Lancet Psychiatry*. Click here to read the article.

Lengel, G. J., Muehlenkamp, J. J., Zetterqvist, M., Ammerman, B. A., Brausch, A. M., & Washburn, J. J. (2025). Non-suicidal self-injury: proposal to shift designation from disorder to a clinical specifier. *The Lancet Psychiatry*, S2215-0366(25)00169-5. Advance online publication. [https://doi.org/10.1016/S2215-0366\(25\)00169-5](https://doi.org/10.1016/S2215-0366(25)00169-5)

Bernanke, A., Roldan, C., & Hamm, B. (2025). The ethics of TMS in the treatment of suicidal ideation. In V. Dubljević & J. R. Young (Eds.), *TMS and Neuroethics* (pp. 213-229). Springer. https://doi.org/10.1007/978-3-031-92401-9_13

Corona, L. E., Hirsch, J. A., Talton, A., Rosoklija, I., Whitehead, J., Papadakis, J., Chen, D., Finlayson, C., Cheng, E. Y., Yerkes, E. B., & Johnson, E. K. (2025). Decision-making experiences in gonadectomy and gonadal tissue cryopreservation for adolescents/young adults and parents of individuals with differences of sex development: A qualitative study. *Journal of Pediatric Urology*, S1477-5131(25)00391-2. Advance online publication. <https://doi.org/10.1016/j.jpuro.2025.07.009>

Geoffroy, P. A., Chevret, S., Mauries, S., Chaffaut, C., Amad, A., Bellivier, F., Benard, V., Courtet, P., Dubertret, C., Gorwood, P., Mazer, N., Mekaoui, L., Olié, E., Pataud, G., Vaiva, G., Lejoyeux, M., Sit, D., & Maruani, J. (2025). Bright Light Therapy in the Morning or Midday for the Treatment of Nonseasonal Depression in Bipolar Disorder (LuBi): A Dose-Escalation Phase 1/2 Randomized Double-Blind Trial. *The Journal of Clinical Psychiatry*, 86(3). <https://doi.org/10.4088/JCP.25m15826>

Geoffroy, P. A., Palagini, L., Henriksen, T. E. G., Bourgin, P., Garbaza, C., Gronfier, C., Esaki, Y., Fernandez, D. C., Lam, R. W., Lee, H. J., Lejoyeux, M., Maruani, J., Martiny, K., Murray, G., Riemersma-Van Der Lek, R. F., Ritter, P., Schulte, P. F. J., Smith, D. J., Terman, M., Zeitzer, J. M., ... Sit, D. K. (2025). Light therapy for bipolar disorders: Clinical recommendations from the international society for bipolar disorders (ISBD) Chronobiology and Chronotherapy Task Force. *Dialogues in Clinical Neuroscience*, 27(1), 249–264. <https://doi.org/10.1080/19585969.2025.2533806>

Goldstein, B. N., Goldstein, S., Salzman, D. H., & Angelotta, C. (2025). Decision-Making Capacity: A Curriculum and Evaluation Checklist for Medical Students. *Academic Psychiatry: the journal of the American Association of Directors of Psychiatric Residency Training and the Association for Academic Psychiatry*, 10.1007/s40596-025-02162-2. Advance online publication. <https://doi.org/10.1007/s40596-025-02162-2>

Grzelak, L. N., Glazer, J. E., Klemballa, D. M., Nabb, C. B., Mittal, V. A., Walther, S., Shankman, S. A., & Letkiewicz, A. M. (2025). Depressive symptoms are associated with impaired body affect recognition for neutral expressions. *Journal of Affective Disorders*, 387, 119531. <https://doi.org/10.1016/j.jad.2025.119531>

Ji, M. T., Przybyl, K. J., Harter, A. M., Nemesh, M., Jenz, S. T., Yamazaki, A., Kim, C., Mulligan, M. K., Chen, H., & Redei, E. E. (2025). Early Onset Memory Deficit of WMI Rats Compared to Their Nearly Isogenic WLI Is Reversed by Enriched Environment in Females. *Genes, Brain, and Behavior*, 24(3), e70027. <https://doi.org/10.1111/gbb.70027>

Kruzan, K. P., Ammerman, B., Lengel, G. J., Griffith, J. W., Lucas, K., Nguyen, T., Rushton, K., Washburn, J. J., & Mohr, D. C. (2025). Development and initial test of an online self-assessment of nonsuicidal self-injury severity. *Journal of Affective Disorders*, 387, 119506. <https://doi.org/10.1016/j.jad.2025.119506>

Kruzan, K. P., Washburn, J. J., Aaby, D., Nguyen, T., & Mohr, D. C. (2025). Subgroups of non-suicidal self-injury in a large diverse sample of online help-seekers. *Frontiers in Psychiatry*, 16, 1513685. <https://doi.org/10.3389/fpsy.2025.1513685>

Publications

Kruzan, K.P., Hentges, E., Ramirez, I., & Washburn, J.J. (2025). Identifying subgroups of nonsuicidal self-injury: A systematic review. *PLOS Mental Health*, 2(4): e0000291. <https://doi.org/10.1371/journal.pmen.0000291>

Lengel, G. J., Ammerman, B. A., Bell, K. A., & Washburn, J. J. (2025). The potential impact of nonsuicidal self-injury disorder: Insights from individuals with lived experience. *Qualitative Research in Medicine & Healthcare*, 8(Suppl 1), 12631. <https://doi.org/10.4081/qrmh.2024.12631>

Li, L. Y., Grzelak, L. N., Auerbach, R. P., & Shankman, S. A. (2025). Siblings' similarity in neural responses to loss reflects mechanisms of familial transmission for depression. *Journal of Psychiatric Research*, 181, 286–293. <https://doi.org/10.1016/j.jpsychires.2024.11.069>

Li, L. Y., McGregor, M. M., Sarkas, S. E., Sritharan, A., Massac, L., Valdespino, M., Letkiewicz, A. M., Durham, K., Auerbach, R. P., & Shankman, S. A. (2025). Longitudinal invariance of the Children's Depression Rating Scale-Revised in adolescents. *Psychological Assessment*, 37(8), 383–389. <https://doi.org/10.1037/pas0001392>

Lozano-Goupil, J., Gupta, T., Williams, T. F., Pinkham, A. E., Haase, C. M., Shankman, S. A., & Mittal, V. A. (2025). Automated analysis of clinical interviews indicates altered head movements during social interactions in youth at clinical high-risk for psychosis. *Schizophrenia (Heidelberg, Germany)*, 11(1), 81. <https://doi.org/10.1038/s41537-025-00627-9>

Lozano-Goupil, J., Shankman, S. A., Walther, S., Wuethrich, F., Maher, R. E., Grzelak, L. N., & Mittal, V. A. (2025). Automatic quantification of hand gestures in current and remitted Major Depressive Disorder during oral expression. *Journal of Affective Disorders*, 389, 119684. <https://doi.org/10.1016/j.jad.2025.119684>

Mathalon, D. H., Nicholas, S., Roach, B. J., Billah, T., Lavoie, S., Whitford, T., Hamilton, H. K., Addamo, L., Anohkin, A., Bekinschtein, T., Belger, A., Buccilli, K., Cahill, J., Carrión, R. E., Damiani, S., Dzaif, I., Ebdrup, B. H., Izyurov, I., Jarcho, J., Jenni, R., Shankman, S., Light, G. A. (2025). The electroencephalography protocol for the Accelerating Medicines Partnership® Schizophrenia Program: Reliability and stability of measures. *Schizophrenia (Heidelberg, Germany)*, 11(1), 85. <https://doi.org/10.1038/s41537-025-00622-0>

McGregor, M. M., Li, L. Y., Trivedi, E., Sarkas, S. E., Sritharan, A., Massac, L., Durham, K., Allen, N. B., Auerbach, R. P., & Shankman, S. A. (2025). A longitudinal study of objective dating app usage and its relation to mental health in adolescents. *Journal of Psychopathology and Clinical Science*, 10.1037/abn0000999. Advance online publication. <https://doi.org/10.1037/abn0000999>

Rappaport, B. I., Shankman, S. A., Glazer, J. E., Buchanan, S. N., Weinberg, A., & Letkiewicz, A. M. (2025). Psychometrics of drift-diffusion model parameters derived from the Eriksen flanker task: Reliability and validity in two independent samples. *Cognitive, Affective & Behavioral Neuroscience*, 25(2), 311–328. <https://doi.org/10.3758/s13415-024-01222-8>

Ricardo, A. C., Park, S., Carmona-Powell, E., Larkin, C., Quiroga, A., Fischer, M. J., Lora, C. M., Chen, J., Missikpode, C., Pineda, M., Zhang, X., Hsu, J. Y., Shankman, S., Lash, J., & CRIC Study Investigators (2025). Validation of the Beck Depression Inventory in US Hispanic Patients with CKD. *Clinical Journal of the American Society of Nephrology: CJASN*, 20(4), 495–501. <https://doi.org/10.2215/CJN.0000000655>

Shankman, S. A., Glazer, J. E., Rappaport, B. I., Li, L. Y., Wüthrich, F., Grzelak, L. N., Walther, S., & Mittal, V. A. (2025). Disentangling the effects of daily physical activity and natural white light exposure on affect. *Journal of Psychopathology and Clinical Science*, 134(5), 520–526. <https://doi.org/10.1037/abn0000995>

Shen, P., Swaroop, V. T., Rojas, A. M., Hirsch, J., Chu, D. I., Papadakis, J. L., Bowman, R., & Larson, J. E. (2025). Understanding Orthopaedic and Health-related Quality of Life Outcomes in Patients With Myelomeningocele Functional Classification 1 Spina Bifida in Relationship to Supportive Standing. *Journal of the Pediatric Orthopaedic Society of North America*, 12, 100205. <https://doi.org/10.1016/j.jposna.2025.100205>

Simon, G. E., Garner, B. R., Smith, J. D., Wyman, P. A., Matson, T. E., Chin-Purcell, L., Cero, I., Vermeer, W., Johnson, K. A., Prado, G., & Brown, C. H. (2025). Rollout trial designs in implementation research are often necessary and sometimes preferred. *Implementation Science: IS*, 20(1), 11. <https://doi.org/10.1186/s13012-025-01422-x>

Suhs, M. C., O'Donnell, A., Ellis, J., Weissberg-Benchell, J., Harris, M. A., & Papadakis, J. L. (2025). Evaluating representativeness: recruitment for a virtual family-based intervention focused on the transition from pediatric to adult diabetes care. *Journal of Pediatric Psychology*, 50(5), 433–441. <https://doi.org/10.1093/jpepsy/jsaf023>

Tubman, A., Papadakis, J. L., Finlayson, C., Duquette, D., & Goetsch Weisman, A. (2025). Perspectives From Adolescents and Young Adults with Klinefelter Syndrome on Testosterone Supplementation and Fertility. *Journal of the Endocrine Society*, 9(9), bvaf112. <https://doi.org/10.1210/jeendo/bvaf112>

Tubman, A., Papadakis, J. L., Finlayson, C., Duquette, D., & Weisman, A. G. (2025). Finding acceptance: How adolescents and young adults with Klinefelter Syndrome navigate identity, disclosure, and support. *Journal of Genetic Counseling*, 34(3), e70074. <https://doi.org/10.1002/jgc.4.70074>

Publications

Wüthrich, F., Zindel, M. O., Nadesalingam, N., Nuoffer, M. G., Kyrou, A., Bernard, J. A., Shankman, S. A., Mittal, V. A., Lefebvre, S., & Walther, S. (2025). Reduced finger tapping speed in patients with schizophrenia and psychomotor slowing: an exploratory fMRI study. *Frontiers in Psychiatry*, 16, 1539112. <https://doi.org/10.3389/fpsyt.2025.1539112>

Yuodsnukis, B., Davies, A., Spiecker, N. C., Papadakis, J. L., Dalke, K. B., Chen, D., & van de Grift, T. C. (2025). "They Knew Something Was Different About Me, They Date Raped Me": A Pilot Study on the Sexual Victimization Experiences of Adolescents and Young Adults with Differences of Sex Development/Intersex Variations. *Sexes*, 6(2), 14. <https://doi.org/10.3390/sexes6020014>

Contact Us

Phone

312-695-5060

Email

pbsweb@northwestern.edu

Website

psychiatry.northwestern.edu

Address

211 East Ontario Street - Suite 1100
